

THIS DRAWING IS UNPUBLISHED. RELEASED FOR PUBLICATION
 © COPYRIGHT BY TYCO ELECTRONICS CORPORATION. ALL RIGHTS RESERVED.

| LOC | DIST | REVISIONS | | | |
|-----|------|-------------|---------------|---------|--------|
| P | LTR | DESCRIPTION | DATE | DWN | APVD |
| AD | 00 | G | ECO-05-004683 | 16JAN06 | BSV MM |

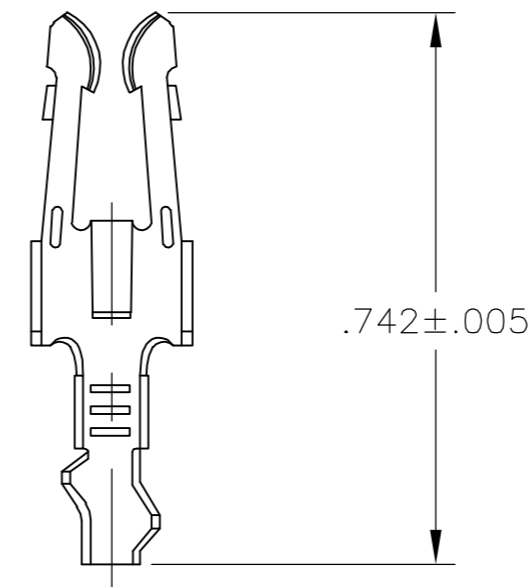
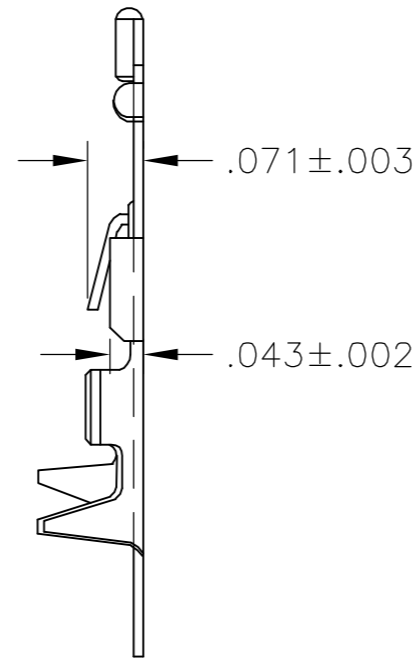
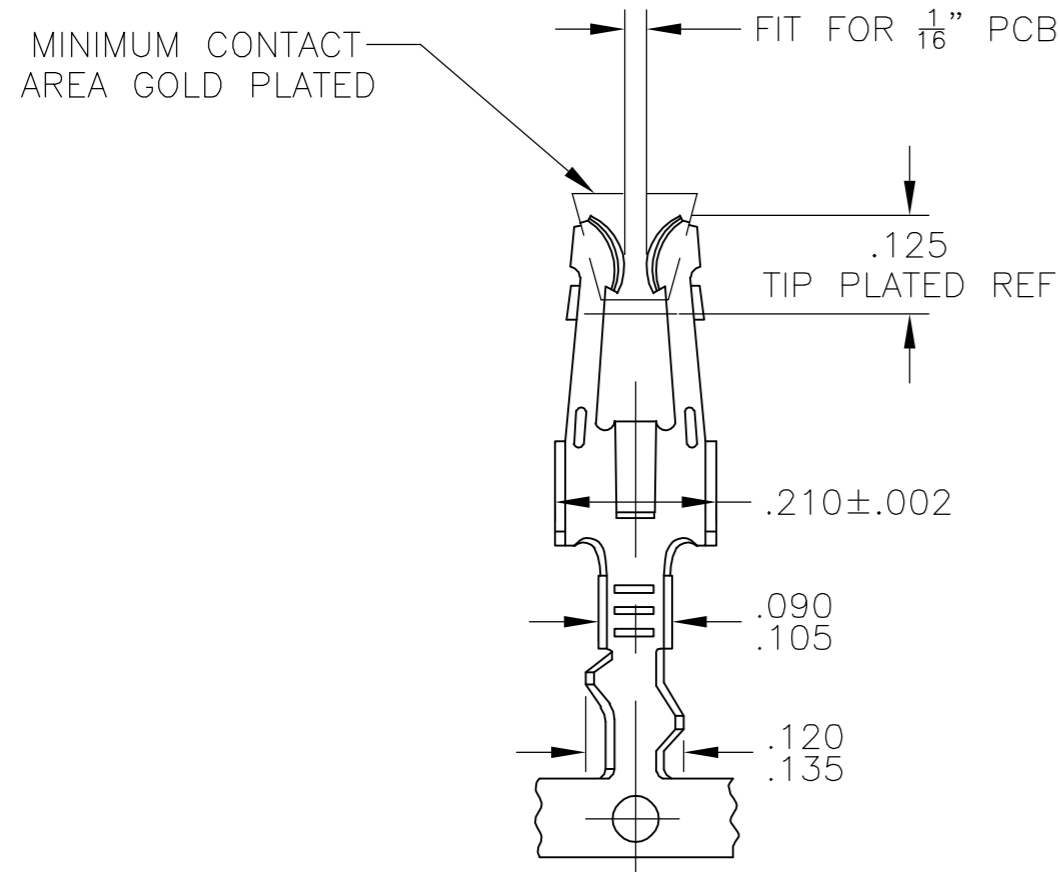

LOOSE PIECE

1. WIRE SIZE: #24-#20 AWG.
 INS. RANGE : .050-.090 DIA

2 MATTE TIN PLATE IN CRIMP AREA.

| | | | | |
|----------|---|----------------------|----|------------|
| | NICKEL PLATE ALL OVER, TIP PLATE .000015 THICK GOLD.REELING L-R FEED FOR MINI-APPLICATOR. | 5-583261-3 | △2 | 5-583259-4 |
| | NICKEL PLATE ALL OVER, TIP PLATE .000015 THICK GOLD.REELING L-R FEED FOR MINI-APPLICATOR. | 5-583261-2 | △2 | 5-583259-3 |
| | TIN REELING L-R FEED FOR MINI APPLICATOR. | 5-583261-1 | △2 | 5-583259-2 |
| OBSELETE | TIN REELING L-R FEED FOR STRIPPER CRIMPER. | 583261-2 | | 583259-5 |
| | NICKEL PLATE ALL OVER, TIP PLATE .000015 THICK GOLD.REELING L-R FEED FOR MINI-APPLICATOR. | 583261-3 | | 583259-4 |
| | NICKEL PLATE ALL OVER, TIP PLATE .000015 THICK GOLD.REELING L-R FEED FOR MINI-APPLICATOR. | 583261-2 | | 583259-3 |
| | TIN REELING L-R FEED FOR MINI APPLICATOR. | 583261-1 | | 583259-2 |
| | FINISH | LOOSE PIECE PART NO. | | PART NO. |

| | | | | | |
|---|--|------------------|-----------|---|----------|
| THIS DRAWING IS A CONTROLLED DOCUMENT. | | DWN | - | Tyco Electronics Corporation Harrisburg, Pa 17105-3608 | |
| DIMENSIONS: INCHES | | CHK | - | | |
| TOLERANCES UNLESS OTHERWISE SPECIFIED: | | APVD | - | | |
| 0 PLC ± - 1 PLC ± - 2 PLC ± - 3 PLC ± - 4 PLC ± - ANGLES ± - | | PRODUCT SPEC | - | NAME | |
| MATERIAL: PHOS. BRONZE | | FINISH | SEE TABLE | MODIFIED FORK CONTACT | |
| | | WEIGHT | - | SIZE | A2 |
| | | CUSTOMER DRAWING | | CAGE CODE | 00779 |
| | | | | DRAWING NO | C=583259 |
| | | | | RESTRICTED TO | - |
| | | | | SCALE | 4:1 |
| | | | | SHEET | 1 OF 1 |
| | | | | REV | G |

583259